

## K ? & - FASCIA, Front/Removal

# REMOVAL

☒ **Labor Operations:** Click to display a list of Labor Operations associated with this procedure

1. Remove the plastic rivets (5) at each wheel well that secure the flares (1) to the fascia (4).
2. Release the clips and partially remove both front fender flares.
3. Remove the fasteners (3) that secure the wheel liners (2) to the fascia (4).

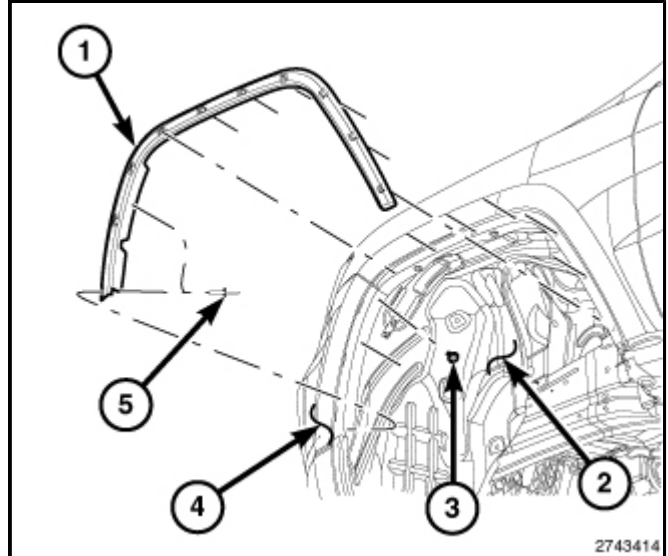

4. Remove the 1/4 turn fasteners (1) and separate the lower wheel liner from the fascia.

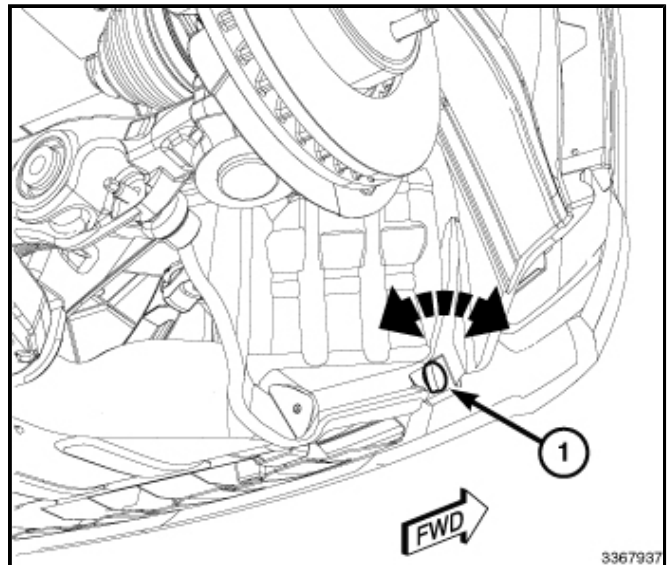

5. Remove the four lower retainers (4).
6. Release the integral latches at the wheel well openings (2) and the radiator grille assembly.
7. Disconnect the fog lamp electrical connectors (3), if equipped.

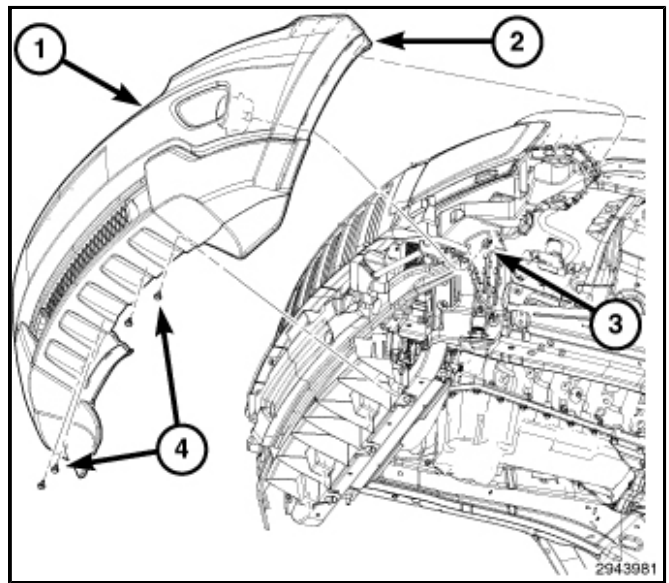

8. Remove the fascia assembly (1).

## K ? & - GRILLE/Removal

# REMOVAL

☒ **Labor Operations:** Click to display a list of Labor Operations associated with this procedure

1. Remove the front fascia assembly
2. Remove the two lower fasteners (3) that secure the radiator grille assembly (2) to the vehicle.
3. Pull up and release the four upper retaining tabs (1) across the radiator core support and remove the grille assembly.

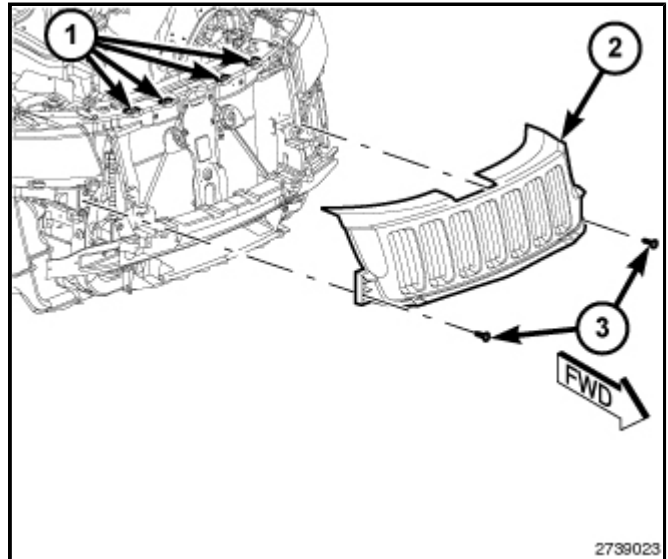

## WK2 - GRILLE/Installation

# INSTALLATION

☒ **Labor Operations:** Click to display a list of Labor Operations associated with this procedure

1. Position the radiator grille assembly (2) on the vehicle.
2. Press firmly across the top of the grille assembly and secure the four retaining tabs (1) to the radiator core support.
3. Install and tighten the two fasteners (3) at the lower corners of the grille.
4. Install the front fascia assembly.

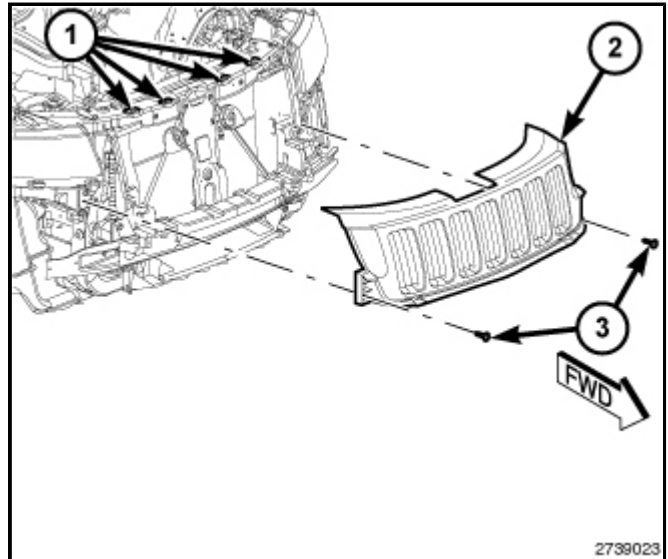

## WK2 - FASCIA, Front/Installation

# INSTALLATION

☒ **Labor Operations:** Click to display a list of Labor Operations associated with this procedure

1. Position the front fascia (1) and connect the fog lamp electrical connectors (3), if equipped.
2. Install the fascia, locking the integral latches at the radiator grille assembly and at the wheel well openings (2).
3. Install the four lower retainers (4).

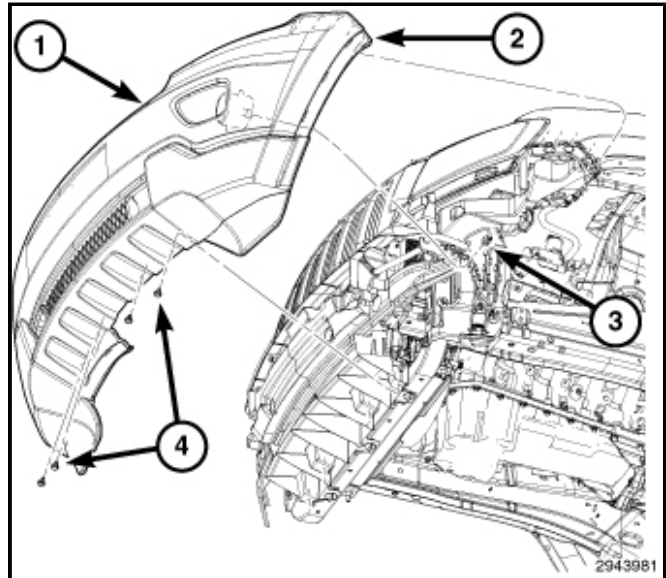

4. Install the fasteners (3) that secure the wheel liners (2) to the fascia (4).
5. Position the front fender flares (1) and press in place, engaging the retaining clips.
6. Install new plastic rivets (5) to secure the fender flares.

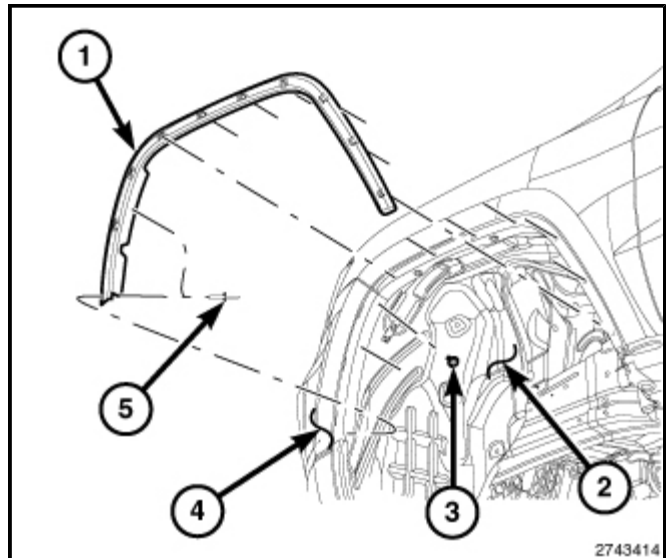

7. Install the 1/4 turn fasteners (1) and secure the lower wheel liner to the fascia.

